

2 Install Transmission

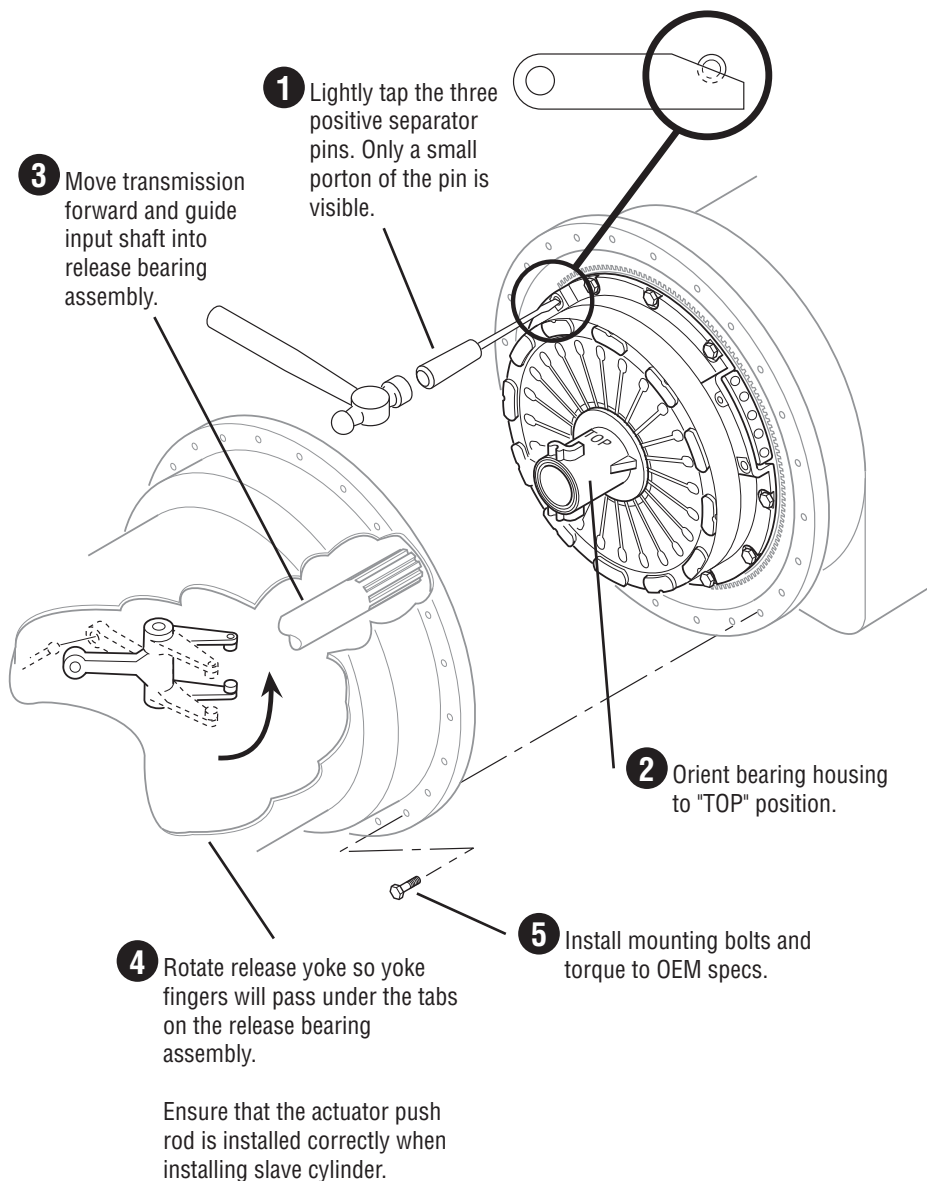

365 mm Clutch Installation Procedure

1 Install Clutch to Flywheel

2 Install Transmission

Eaton Corporation
Clutch Division
 201 Brandon Street
 Auburn, IN 46706

Eaton® Fuller®
365 mm Clutches

Copyright Eaton Corporation, 2001.
 All rights reserved. CLMT-0365 01/11 WP

EATON

1 Measure

Measure Engine Flywheel Housing and Flywheel

Engine flywheel housing and flywheel must meet these specifications or there will be premature clutch wear. Remove old Pilot Bearing. All gauge contact surfaces must be clean and dry. Use a dial indicator and check the following:

Flywheel Face Runout

Secure dial indicator base to flywheel housing face. Put gauge finger in contact with flywheel face near outer edge. Rotate flywheel one revolution. Maximum runout is **.007"** (.18 mm).

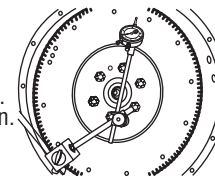

Flywheel Housing I.D. Runout

Secure dial indicator base to crankshaft. Put gauge finger against flywheel housing pilot I.D. Rotate flywheel one revolution. Maximum runout is **.008"** (.20 mm).

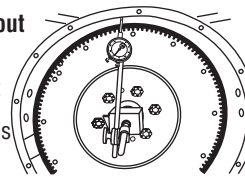

Pilot Bearing Bore Runout

Secure dial indicator base to flywheel housing face. Position gauge finger so that it contacts pilot bearing bore. Rotate flywheel one revolution. Maximum runout is **.005"** (.13 mm).

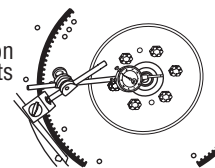

Flywheel Housing Face Runout

Secure dial indicator base to flywheel near the outer edge. Put gauge finger in contact with face of flywheel housing. Rotate flywheel one revolution. Maximum runout is **.008"** (.20 mm).

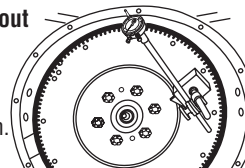

1 Install Clutch to Flywheel

For 365 mm Two Plate Clutch:

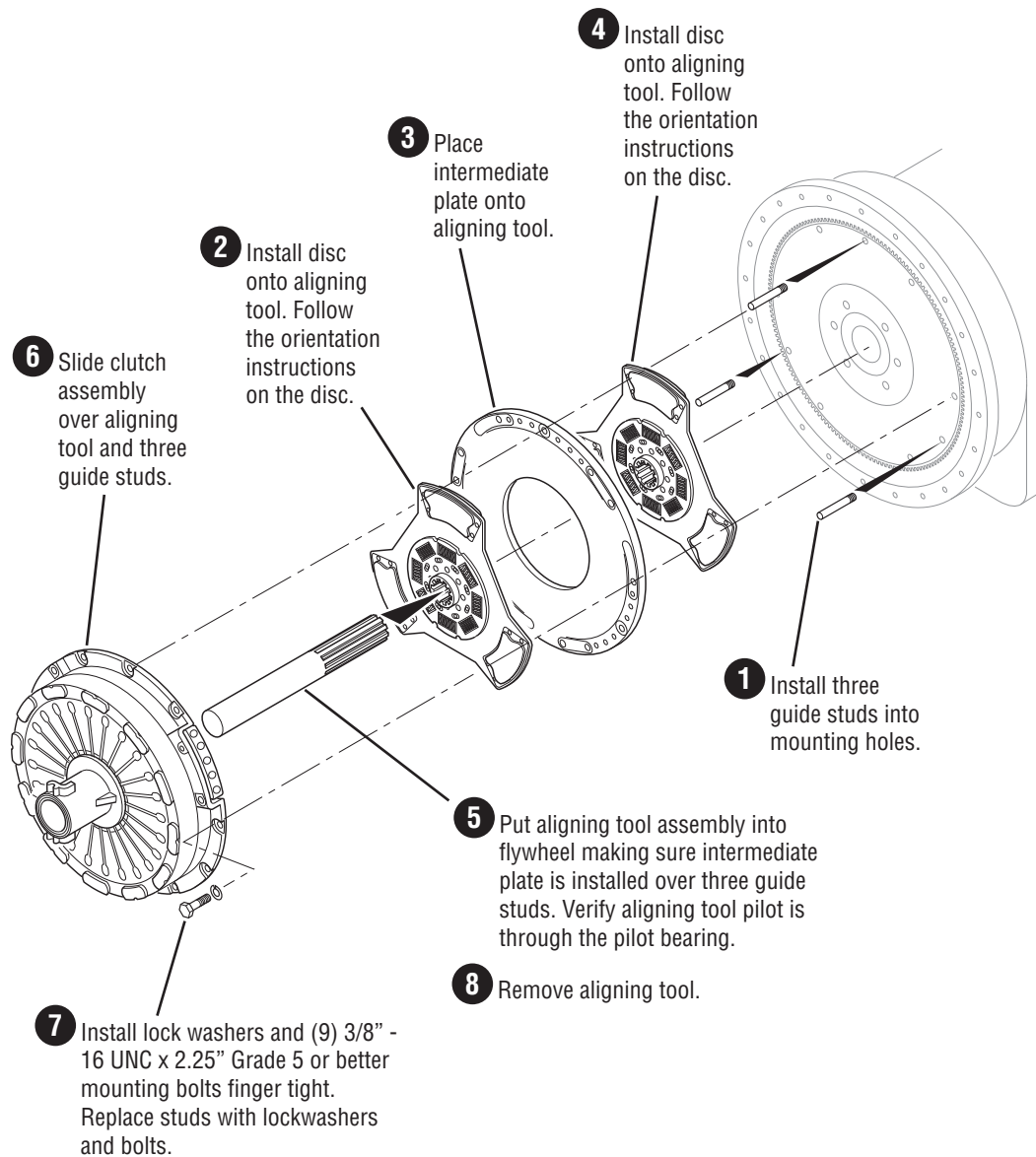

Progressively tighten mounting bolts in a crisscross pattern starting with a lower bolt. Torque to 30-35 lbs. ft. (40-47 N•m).

For 365 mm Single Plate Clutch:

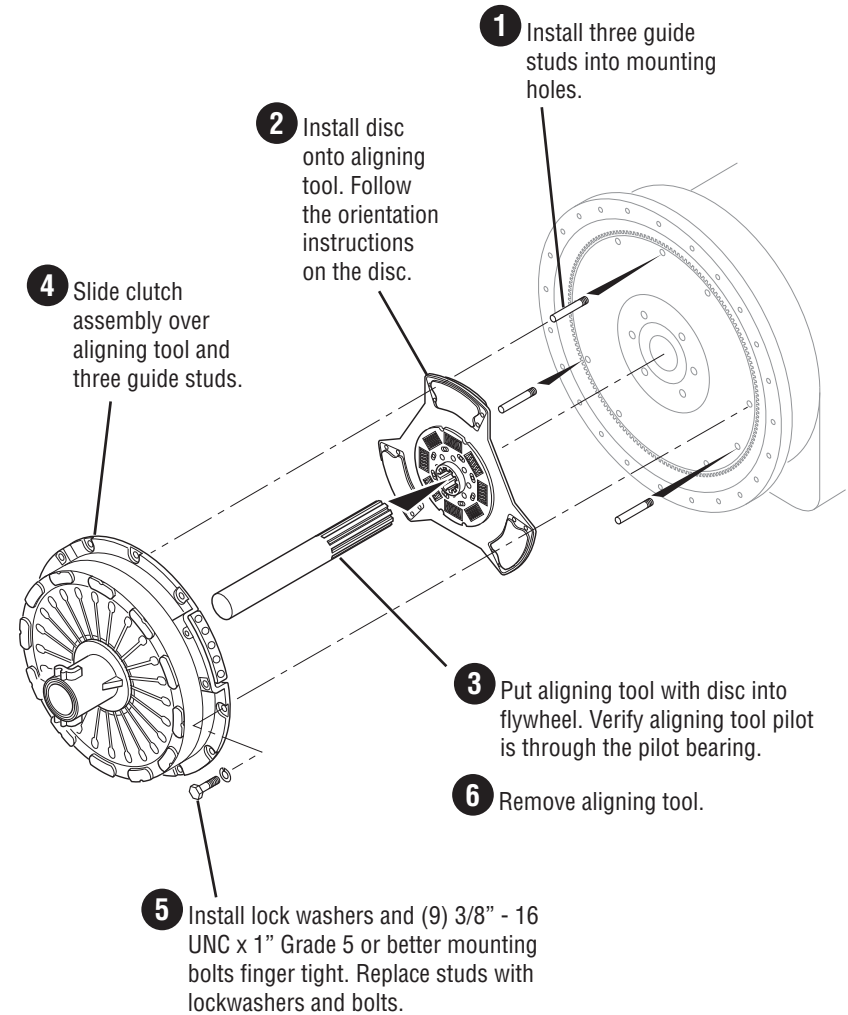

Progressively tighten mounting bolts in a crisscross pattern starting with a lower bolt. Torque to 30-35 lbs. ft. (40-47 N•m).